

**CAUSEWAY ALLIANCE**  
working for our **thriving** city

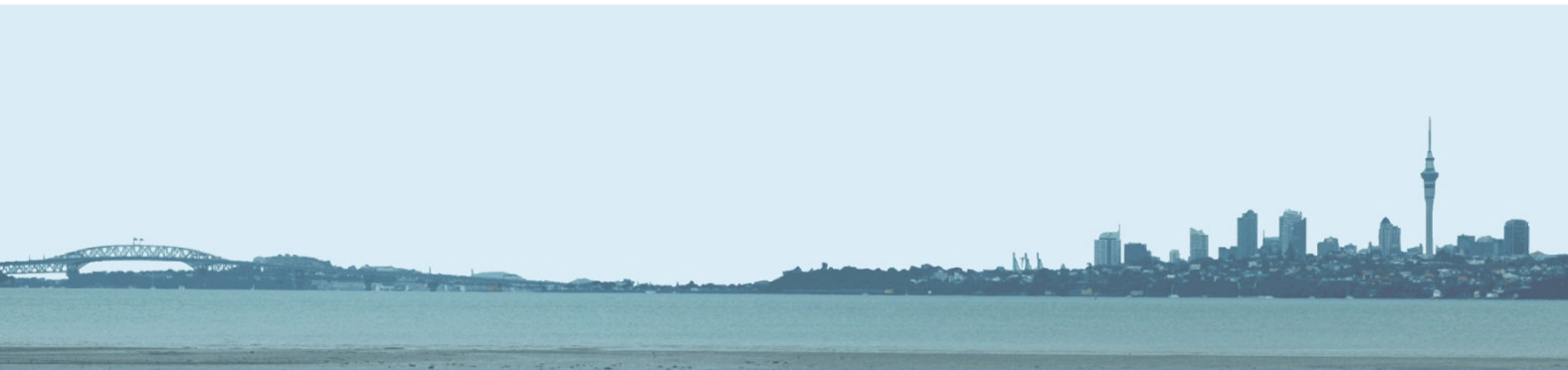

## SH16 CAUSEWAY UPGRADE PROJECT



Monthly Environmental Report  
October 2013

## Document history and status

Revision	Date issued	Written By	Reviewed by	Approved by	Revision Status
A	18.11.2013	K Stevens	E Collins / R Purdy / B Dunbar		For REVIEW
B	21.11.13	K Stevens	M Evans		For Approval/Release
C	21.11.13	K Stevens	M Evans	M Evans	FINAL

## Distribution of copies

Revision	Purpose	Issued to
A	For review	E Collins/B Dunbar/R Purdy
B	For approval/release	M Evans
C	FINAL	Auckland Council

<b>Printed:</b>	25/11/2013 09:38
<b>Last saved:</b>	25/11/2013 09:38
<b>File name:</b>	K:\EN Environment\EN51 Construction\04 Council Reporting\Monthly Report\2013 06 Report\June 2013 Causeway Upgrade Project Monthly Environmental ReportECverA.docx
<b>Author:</b>	Kevin Stevens
<b>Environmental Manager:</b>	Michael Cassidy
<b>Name of organisation:</b>	Causeway Alliance
<b>Name of project:</b>	SH16 Causeway Upgrade Project
<b>Document version:</b>	<b>Revision C</b>

# Contents

1.0	INTRODUCTION	7
1.1	PURPOSE OF THE REPORT	7
2.0	OVERVIEW of ACTIVITIES UNDERTAKEN	7
2.1	Environmental	7
2.2	Communications and Stakeholder Management	7
2.3	Key Stakeholder Milestones	7
2.4	Construction	8
3.0	MEETINGS, INSPECTIONS & EVENTS	8
4.0	ENVIRONMENTAL MONITORING	8
4.1	EARTHWORKS COMPLIANCE	8
4.2	CONSTRUCTION NOISE & VIBRATION	8
4.3	AIR QUALITY	9
4.4	CONTAMINATED SOIL	9
4.5	EROSION AND SEDIMENT CONTROL	9
4.6	ARCHAEOLOGICAL	9
4.7	COASTAL MONITORING	9
4.8	MARINE MONITORING	9
4.9	ECOLOGICAL	9
5.0	CORRESPONDENCE ON CONSENT CONDITIONS AND PLANS	10
6.0	WORKS PROPOSED FOR NOVEMBER 2013	10

**Appendix A:** SH16 Causeway Alliance Construction Zone Plan

**Appendix B:** SH16 Causeway Imported and Exported Material Summary

## **1.0 INTRODUCTION**

### **1.1 PURPOSE OF THE REPORT**

---

To provide Auckland Council with a monthly overview of construction progress and compliance activity on the SH16 Causeway Upgrade project.

This report describes and details activities during the month of October 2013.

## **2.0 OVERVIEW of ACTIVITIES UNDERTAKEN**

### **2.1 Environmental**

---

Regular contact is continuing with the Auckland Council compliance team.

The final Urban Design and Landscape Plan was submitted to Auckland Council for compliance certification.

### **2.2 Communications and Stakeholder Management**

---

A second meeting was held on 18 October with Te Kawerau a Maki and Ngati Whatua Iwi representatives and Auckland Council's urban designer (and also Auckland Council's archaeologist). The purpose of the meeting was to identify possible cultural and heritage opportunities along the shared path, which could be considered as an additional 'legacy' of the project. A site meeting was held on 23 October with Iwi and Auckland Council's urban designer to review the proposed sites and design ideas. These meetings assisted in completing the final Urban Design and Landscape Plan.

Media, social media, website and print local newspaper and magazine updates were provided on the rollout of the new T2 lane at Great North Road interchange (GNRI) and the importance of the 80kph speed limit.

Class visits to the Causeway Alliance's base from Rutherford Primary and Flanshaw Road Primary included a focus on environmental protection measures being progressed by the project team.

### **2.3 Key Stakeholder Milestones**

---

- Produced fortnightly Causeway News project updates to stakeholders, project neighbours and wider community
- Meeting with Iwi to understand opportunities to incorporate features which recognise cultural and heritage features in the area.

Positive feedback and no complaints were received from residents, local or regional stakeholders.

## **2.4 Construction**

---

- Alwyn Ave - earthworks undertaken adjacent to shared path to create access down to Whau River Bridge abutment (south-west side).
- Whau River Bridge (north-west) – ground improvements and revetment rock installation under existing bridge.
- Whau River Bridge (north-east) - working platform established and ground improvements (vibro cement columns) completed. Installation of temporary staging units underway.
- Rosebank Park Domain – no progress while traffic management plan to relocate existing shared path is being approved.
- Causeway (from North Traherne Island in an easterly direction) – continue installing drainage layer, wick drains, ground monitoring instrumentation and advancing the coffer dam and working platform in the Coastal Marine Area. Commence installation of the preload fill layer.
- Causeway (South Traherne Island) – commence earthworks for the working platform and drainage layer in preparation for wick drain installation.
- GNRI (northern side, eastbound from Causeway Bridge) – site clearance, haul road completed, earthworks commenced from Causeway Bridge in preparation for wick drain installation.
- GNRI (southern side, westbound towards Causeway Bridge) – shared path diversion, coffer dam, earthworks, utilities trench and complete rock lining of Oakley Creek channel. Ground investigations to establish extent of basalt layer.

## **3.0 MEETINGS, INSPECTIONS & EVENTS**

---

3, 17 and 31 October – Council’s Earthworks Compliance Inspections

## **4.0 ENVIRONMENTAL MONITORING**

### **4.1 EARTHWORKS COMPLIANCE**

---

Compliance Inspections were completed by Auckland Council officers on the 3, 17 and 31 October and all recorded a compliance score of 1 (Full Compliance).

### **4.2 CONSTRUCTION NOISE & VIBRATION**

---

SSNMP #5 was submitted and approved for directional drilling and loop cutting night works at GNRI in October 2013.

### **4.3 AIR QUALITY**

---

No air quality complaints or issues were received during the period, or were recorded on Causeway Alliance Daily Site Reports.

### **4.4 CONTAMINATED SOIL**

---

A summary of imported material sources and exported material disposal locations, classifications sample methods and quantities at various site locations during October is included in Appendix B.

### **4.5 EROSION AND SEDIMENT CONTROL**

---

CESCP No. 16 for widening on the northern side of SH16 between Patiki off-ramp and Rosebank on-ramp was approved on 30 October.

### **4.6 ARCHAEOLOGICAL**

---

Inspection of archaeological site at the GNRI eastbound off-ramp site (old Stone Wall) on 10 October with Council's archaeologist and NZ Historic Places Trust.

### **4.7 COASTAL MONITORING**

---

No coastal monitoring inspections were completed in October.

### **4.8 MARINE MONITORING**

---

No marine monitoring was undertaken during the period.

### **4.9 ECOLOGICAL**

---

Four inspections of Significant and Valued vegetation were undertaken during the period at Traherne Island, Whau River Bridge, Patiki to Rosebank (eastbound) and Alwyn Avenue.

A replanting plan has been developed for the area where there was an over clearance of vegetation on Traherne Island South. This was reviewed by Auckland Council, DoC, NZTA and AMA. The Plan proposes replanting the area using a range of species raised from seeds obtained from Traherne Island.

Monthly assessment of avian roosting locations was undertaken in Zone 3 (Harbourview-Orangihina). The monthly avian count for October was 12 birds compared to the pre-establishment baseline count in October 2010 of 11 birds.

Planning continues for the installation of temporary bird roost sites (floating pontoons) south of Causeway Bridge.

## **5.0 CORRESPONDENCE ON CONSENT CONDITIONS AND PLANS**

---

Letter dated 7 October received from Auckland Council responding to the vegetation over clearance incident on Traherne Island south.

## **6.0 WORKS PROPOSED FOR NOVEMBER 2013**

---

Refer Appendix A for Construction Zone Plan.

### **Zone 1 Causeway**

- Continue installing the working platform, drainage blanket, wick drains, coffer dam and reclamation in the coastal area on both sides of the Causeway and across Traherne Island.

### **Zone 2 / Zone 3 Whau to Rosebank**

- Continue the access track from Alwyn Ave down to the Whau River Bridge (south-west). Continue installing temporary staging units on the north-east side of Whau River Bridge. Continue installing rock protection under Whau River Bridge (western abutment).
- Establish shared path diversion from Patiki overbridge to Whau Bridge (around Rosebank Park Domain).
- Vegetation clearance on north side between Patiki off ramp and Rosebank on ramp and establish access for retaining wall construction.

### **Zone 5 GNRI**

- East bound: Mangrove removal, establish coffer dam and commence earthworks to widen the embankment east of the Causeway Bridge and alongside Great North Road east-bound off-ramp.
- Westbound: Divert cyclists along new shared path route along the old bus shoulder lane, continue raising fill embankment.

The environmental focus for November will continue to be on inspections prior to and during vegetation removal and ground clearance to ensure ecological and archaeological stand over requirements are met. The establishment and monitoring of sediment and erosion controls will also continue.

## **Appendix A: SH16 Causeway Alliance Construction Zone Plan**



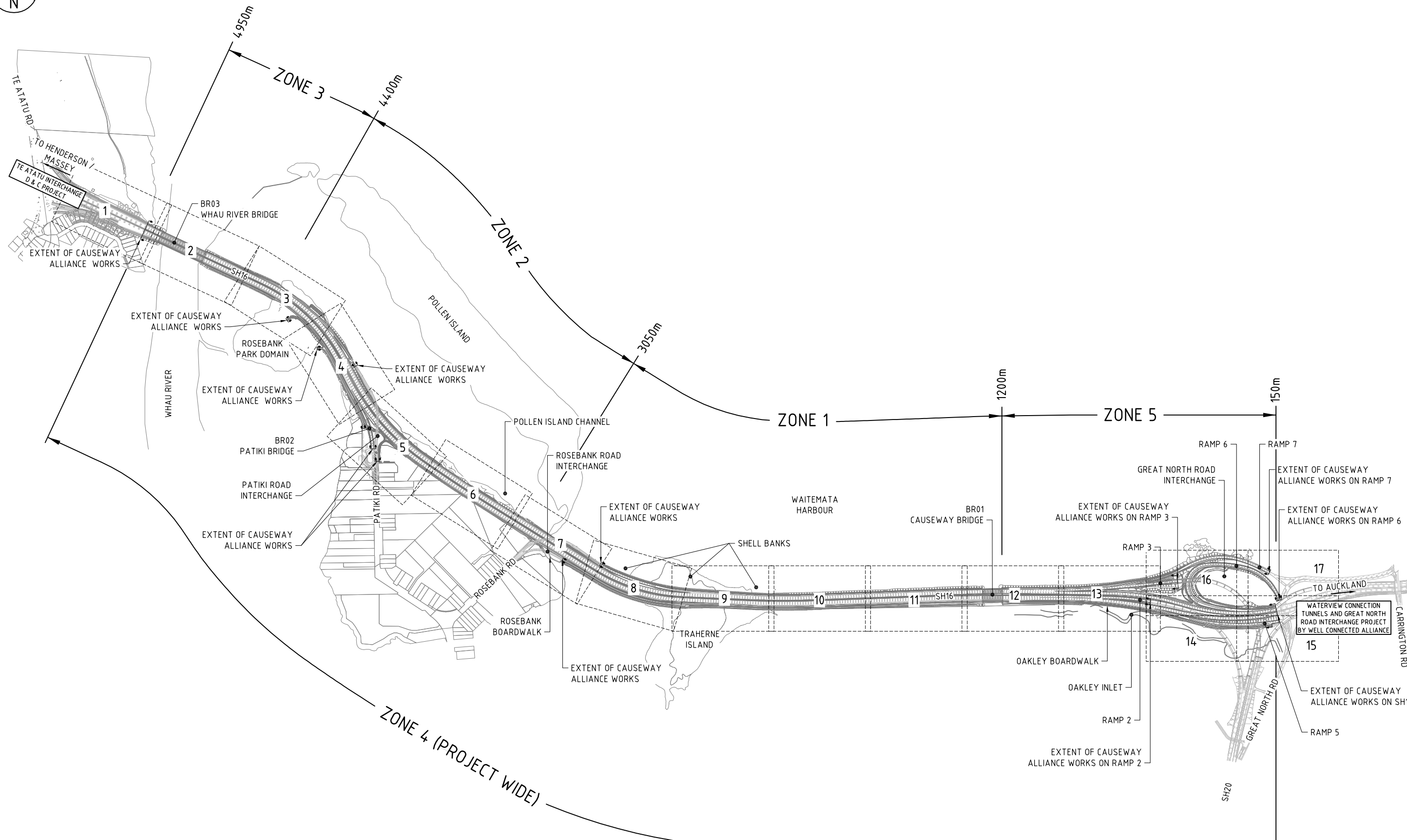

**Appendix B: SH16 Causeway Imported and Exported Material Summary**

Date	Transport Subcontractor	Zone	Docket #	Source	From Area	Gate	From Description	From Change	To Area	Sample ID	Lab Report ID	Classification	Acceptable Disposal Facilities	Confine	To Description	To Change	Fill Type	Material Type	Type of work	Task code	Truck Type	Driver	Truck Reg	Load Count	Truck Volume (ft <sup>3</sup> )	Total Volume (ft <sup>3</sup> )	Total Volume (m <sup>3</sup> )	Sample Rate	Source - Material Type	To Description - Fill Type - Material Type	Month Required	Month	#	
Tuesday, 1 October 2013	GAC	Area West			Shear Key / Undercut NW Whau				Taupou Skopiple	CA16_0-05-0-2, CA16_1-0-1-2, CA17_0-05-0-2, CA17_1-0-1-2	1175713	Clearfill	Greenmount Clearfill, Ridge Road Clearfill, (Pukekohe Island Clearfill)	Kept onsite	Taupou Skopiple		Cut to Waste	Cut to Waste				6 Wheeler		51	3	30	48	Exact total volume removed from area to date unknown. AECOM was advised average load of 6 wheeler to be 10 T. AECOM has used 10 T as a conversion guide. Based on this, 628 m <sup>3</sup> of material was previously moved in September and kept onsite. Total volume removed on 1 October was 144 m <sup>3</sup> . Total volume removed to date 872 m <sup>3</sup> . Four samples relate to NW Whau. The current sample rate is one sample per 192 m <sup>3</sup> . This meets the minimum sampling requirements of 1 sample per 1,000 m <sup>3</sup> .	Shear Key / Undercut NW Whau - Cut to Waste	Taupou Skopiple - Cut to Waste - Cut to Waste	Oct-13	Oct-13	2603	
Tuesday, 1 October 2013	GAC	Area West			Shear Key / Undercut NW Whau				Taupou Skopiple						Taupou Skopiple		Cut to Waste	Cut to Waste						56	6	60	96	Total volume disposed to date 788 m <sup>3</sup> (includes 672 m <sup>3</sup> already disposed in September/October). Four samples relate to NW Whau. The current sample rate is one sample per 192 m <sup>3</sup> . This meets the minimum sampling requirements of 1 sample per 1,000 m <sup>3</sup> .	Shear Key / Undercut NW Whau - Cut to Waste	Taupou Skopiple - Cut to Waste - Cut to Waste	Oct-13	Oct-13	2606	
Wednesday, 2 October 2013	GAC	Area West			Shear Key / Undercut NW Whau				Taupou Skopiple						Taupou Skopiple		Cut to Waste	Cut to Waste						56	1	10	16	Total volume disposed to date 784 m <sup>3</sup> (includes 672 m <sup>3</sup> already disposed in September/October). Four samples relate to NW Whau. The current sample rate is one sample per 196 m <sup>3</sup> . This meets the minimum sampling requirements of 1 sample per 1,000 m <sup>3</sup> .	Shear Key / Undercut NW Whau - Cut to Waste	Taupou Skopiple - Cut to Waste - Cut to Waste	Oct-13	Oct-13	2609	
Wednesday, 2 October 2013	GAC	Area West			Shear Key / Undercut NW Whau				Taupou Skopiple	CA16_0-05-0-2, CA16_1-0-1-2, CA17_0-05-0-2, CA17_1-0-1-2	1175713	Clearfill	Greenmount Clearfill, Ridge Road Clearfill, (Pukekohe Island Clearfill)	Kept onsite	Taupou Skopiple		Cut to Waste	Cut to Waste							0	0	0	0	Total volume disposed to date 816 m <sup>3</sup> (includes 784 m <sup>3</sup> already disposed in September/October). Four samples relate to NW Whau. The current sample rate is one sample per 204 m <sup>3</sup> . This meets the minimum sampling requirements of 1 sample per 1,000 m <sup>3</sup> .	Shear Key / Undercut NW Whau - Cut to Waste	Taupou Skopiple - Cut to Waste - Cut to Waste	Oct-13	Oct-13	2612
Wednesday, 2 October 2013	GAC	Area West			Shear Key / Undercut NW Whau				Taupou Skopiple						Taupou Skopiple		Cut to Waste	Cut to Waste						15	2	20	32	Total volume disposed to date 816 m <sup>3</sup> (includes 784 m <sup>3</sup> already disposed in September/October). Four samples relate to NW Whau. The current sample rate is one sample per 204 m <sup>3</sup> . This meets the minimum sampling requirements of 1 sample per 1,000 m <sup>3</sup> .	Shear Key / Undercut NW Whau - Cut to Waste	Taupou Skopiple - Cut to Waste - Cut to Waste	Oct-13	Oct-13	2791	
Wednesday, 2 October 2013	GAC	Zone 5	Area 1	Area 1	Area 1	C12		Area 3							Zone 5 - Impaired Fill		Gap 100 Spec	Permanent	30.510	6 wheeler	mech					10				Area 1 - Gap 100 Spec	Area 3 - Gap 100 Spec	Oct-13	Oct-13	2796
Thursday, 3 October 2013	GAC	Area West			Shear Key / Undercut NW Whau				Taupou Skopiple	CA16_0-05-0-2, CA16_1-0-1-2, CA17_0-05-0-2, CA17_1-0-1-2	1175713	Clearfill	Greenmount Clearfill, Ridge Road Clearfill, (Pukekohe Island Clearfill)	Kept onsite	Taupou Skopiple		Cut to Waste	Cut to Waste							56	4	40	64	Total volume disposed to date 880 m <sup>3</sup> (includes 816 m <sup>3</sup> already disposed in September/October). Four samples relate to NW Whau. The current sample rate is one sample per 220 m <sup>3</sup> . This meets the minimum sampling requirements of 1 sample per 1,000 m <sup>3</sup> .	Shear Key / Undercut NW Whau - Cut to Waste	Taupou Skopiple - Cut to Waste - Cut to Waste	Oct-13	Oct-13	2798
Thursday, 3 October 2013	GAC	Area West			Shear Key / Undercut NW Whau				Taupou Skopiple						Taupou Skopiple		Cut to Waste	Cut to Waste						15	5	50	80	Total volume disposed to date 907 m <sup>3</sup> (includes 880 m <sup>3</sup> already disposed in September/October). Four samples relate to NW Whau. The current sample rate is one sample per 240 m <sup>3</sup> . This meets the minimum sampling requirements of 1 sample per 1,000 m <sup>3</sup> .	Shear Key / Undercut NW Whau - Cut to Waste	Taupou Skopiple - Cut to Waste - Cut to Waste	Oct-13	Oct-13	2792	
Thursday, 3 October 2013	GAC	Area West	1444382		Shear Key / Undercut NW Whau				Greenmount Landfill						Greenmount Landfill		Cut to Waste	Clean Fill						40	26.64	43.24		Shear Key / Undercut NW Whau - Clean Fill	Greenmount Landfill - Cut to Waste - Clean Fill	Oct-13	Oct-13	2836		
Thursday, 3 October 2013	GAC	Area West	1444462		Shear Key / Undercut NW Whau				Greenmount Landfill						Greenmount Landfill		Cut to Waste	Clean Fill						30	36.02	41.62		Shear Key / Undercut NW Whau - Clean Fill	Greenmount Landfill - Cut to Waste - Clean Fill	Oct-13	Oct-13	2837		
Thursday, 3 October 2013	GAC	Area West	1444371		Shear Key / Undercut NW Whau				Greenmount Landfill						Greenmount Landfill		Cut to Waste	Clean Fill						30	26.9	43.04		Shear Key / Undercut NW Whau - Clean Fill	Greenmount Landfill - Cut to Waste - Clean Fill	Oct-13	Oct-13	2838		
Thursday, 3 October 2013	GAC	Area West	1444469		Shear Key / Undercut NW Whau				Greenmount Landfill	CA16_0-05-0-2, CA16_1-0-1-2, CA17_0-05-0-2, CA17_1-0-1-2	1175713	Clearfill	Greenmount Clearfill, Ridge Road Clearfill, (Pukekohe Island Clearfill)	Yes - CA16_0-05-0-2 had lead and nickel concentrations slightly above Auckland background ranges, though under the acceptance criteria for all three clearfill disposal sites.	Greenmount Landfill		Cut to Waste	Clean Fill							37	23.96	38.36		Shear Key / Undercut NW Whau - Clean Fill	Greenmount Landfill - Cut to Waste - Clean Fill	Oct-13	Oct-13	2839	
Thursday, 3 October 2013	GAC	Area West	1444448		Shear Key / Undercut NW Whau				Greenmount Landfill						Greenmount Landfill		Cut to Waste	Clean Fill						40	25.96	41.536		Shear Key / Undercut NW Whau - Clean Fill	Greenmount Landfill - Cut to Waste - Clean Fill	Oct-13	Oct-13	2840		
Thursday, 3 October 2013	GAC	Area West	1444444		Shear Key / Undercut NW Whau				Greenmount Landfill						Greenmount Landfill		Cut to Waste	Clean Fill						42	22.96	36.768		Shear Key / Undercut NW Whau - Clean Fill	Greenmount Landfill - Cut to Waste - Clean Fill	Oct-13	Oct-13	2841		
Thursday, 3 October 2013	GAC	Area West	1444381		Shear Key / Undercut NW Whau				Greenmount Landfill						Greenmount Landfill		Cut to Waste	Clean Fill						42	24.38	39.008		Shear Key / Undercut NW Whau - Clean Fill	Greenmount Landfill - Cut to Waste - Clean Fill	Oct-13	Oct-13	2842		
Friday, 4 October 2013	GAC	Area West			Shear Key / Undercut NW Whau				Taupou Skopiple	CA16_0-05-0-2, CA16_1-0-1-2, CA17_0-05-0-2, CA17_1-0-1-2	1175713	Clearfill	Greenmount Clearfill, Ridge Road Clearfill, (Pukekohe Island Clearfill)	Kept onsite	Taupou Skopiple		Cut to Waste	Cut to Waste							56	7	70	112	Total volume disposed to date 1355 m <sup>3</sup> (includes 1243 m <sup>3</sup> already disposed in September/October). Four samples relate to NW Whau. The current sample rate is one sample per 339 m <sup>3</sup> . This meets the minimum sampling requirements of 1 sample per 1,000 m <sup>3</sup> .	Shear Key / Undercut NW Whau - Cut to Waste	Taupou Skopiple - Cut to Waste - Cut to Waste	Oct-13	Oct-13	2847
Friday, 4 October 2013	GAC	Area West			Shear Key / Undercut NW Whau				Taupou Skopiple						Taupou Skopiple		Cut to Waste	Cut to Waste						56	4	40	64	Total volume disposed to date 1355 m <sup>3</sup> (includes 1243 m <sup>3</sup> already disposed in September/October). Four samples relate to NW Whau. The current sample rate is one sample per 339 m <sup>3</sup> . This meets the minimum sampling requirements of 1 sample per 1,000 m <sup>3</sup> .	Shear Key / Undercut NW Whau - Cut to Waste	Taupou Skopiple - Cut to Waste - Cut to Waste	Oct-13	Oct-13	2849	
Friday, 4 October 2013	GAC	Area West	1444846		Shear Key / Undercut NW Whau				Greenmount Landfill						Greenmount Landfill		Cut to Waste	Cut to Waste						19	28.32	45.12		Shear Key / Undercut NW Whau - Cut to Waste	Greenmount Landfill - Cut to Waste - Cut to Waste	Oct-13	Oct-13	2851		
Friday, 4 October 2013	GAC	Area West	1444846		Shear Key / Undercut NW Whau				Greenmount Landfill						Greenmount Landfill		Cut to Waste	Cut to Waste						30	25.68	41.688		Shear Key / Undercut NW Whau - Cut to Waste	Greenmount Landfill - Cut to Waste - Cut to Waste	Oct-13	Oct-13	2850		
Friday, 4 October 2013	GAC	Area West	1444845		Shear Key / Undercut NW Whau				Greenmount Landfill						Greenmount Landfill		Cut to Waste	Cut to Waste						30	24.9	39.84		Shear Key / Undercut NW Whau - Cut to Waste	Greenmount Landfill - Cut to Waste - Cut to Waste	Oct-13	Oct-13	2852		
Friday, 4 October 2013	GAC	Area West	1444600		Shear Key / Undercut NW Whau				Greenmount Landfill						Greenmount Landfill		Cut to Waste	Cut to Waste						37	31.5	50.4		Shear Key / Undercut NW Whau - Cut to Waste	Greenmount Landfill - Cut to Waste - Cut to Waste	Oct-13	Oct-13	2853		
Friday, 4 October 2013	GAC	Area West	1444529		Shear Key / Undercut NW Whau				Greenmount Landfill	CA16_0-05-0-2, CA16_1-0-1-2, CA17_0-05-0-2, CA17_1-0-1-2	1175713	Clearfill	Greenmount Clearfill, Ridge Road Clearfill, (Pukekohe Island Clearfill)	Yes - CA16_0-05-0-2 had lead and nickel concentrations slightly above Auckland background ranges, though under the acceptance criteria for all three clearfill disposal sites.	Greenmount Landfill		Cut to Waste	Cut to Waste							37	30.14	48.224		Shear Key / Undercut NW Whau - Cut to Waste	Greenmount Landfill - Cut to Waste - Cut to Waste	Oct-13	Oct-13	2854	
Friday, 4 October 2013	GAC	Area West	1444522		Shear Key / Undercut NW Whau				Greenmount Landfill						Greenmount Landfill		Cut to Waste	Cut to Waste						19	26.48	42.368		Shear Key / Undercut NW Whau - Cut to Waste	Greenmount Landfill - Cut to Waste - Cut to Waste	Oct-13	Oct-13	2855		
Friday, 4 October 2013	GAC	Area West	1444572		Shear Key / Undercut NW Whau				Greenmount Landfill						Greenmount Landfill		Cut to Waste	Cut to Waste						19	25.96	41.536		Shear Key / Undercut NW Whau - Cut to Waste	Greenmount Landfill - Cut to Waste - Cut to Waste	Oct-13	Oct-13	2856		
Friday, 4 October 2013	GAC	Area West	1444595		Shear Key / Undercut NW Whau				Greenmount Landfill						Greenmount Landfill		Cut to Waste	Cut to Waste						42	23.7	37.92		Shear Key / Undercut NW Whau - Cut to Waste	Greenmount Landfill - Cut to Waste - Cut to Waste	Oct-13	Oct-13	2857		
Friday, 4 October 2013	GAC	Area West	1444504		Shear Key / Undercut NW Whau				Greenmount Landfill						Greenmount Landfill		Cut to Waste	Cut to Waste						42	34.12	54.624		Shear Key / Undercut NW Whau - Cut to Waste	Greenmount Landfill - Cut to Waste - Cut to Waste	Oct-13	Oct-13	2858		
Friday, 4 October 2013	GAC	Area West	1444477		Shear Key / Undercut NW Whau				Greenmount Landfill						Greenmount Landfill		Cut to Waste	Cut to Waste						37	33.72	53.962		Shear Key / Undercut NW Whau - Cut to Waste	Greenmount Landfill - Cut to Waste - Cut to Waste	Oct-13	Oct-13	2859		
Friday, 4 October 2013	GAC	Zone 1	GC203797	Gate C7	Waste Skopiple	C7			Ridge Road Landfill						Ridge Road Landfill		Cut to Waste	Topsoil / Organics						67	2	38	60.8	Total volume of material disposed 274 m <sup>3</sup> (prior to 4 October no material had been disposed of). Five samples relate to Zone 1F. The current sample rate is one sample per 55 m <sup>3</sup> . This meets the minimum sampling requirements of 1 sample per 1,000 m <sup>3</sup> .	Waste Skopiple - Topsoil / Organics	Ridge Road Landfill - Cut to Waste - Topsoil / Organics	Oct-13	Oct-13	2861	
Friday, 4 October 2013	GAC	Zone 1	GC307025	Gate C7	Waste Skopiple	C7			Ridge Road Landfill						Ridge Road Landfill		Cut to Waste	Topsoil / Organics						44	2	38	60.8	Total volume of material disposed 274 m <sup>3</sup> (prior to 4 October no material had been disposed of). Five samples relate to Zone 1F. The current sample rate is one sample per 55 m <sup>3</sup> . This meets the minimum sampling requirements of 1 sample per 1,000 m <sup>3</sup> .	Waste Skopiple - Topsoil / Organics	Ridge Road Landfill - Cut to Waste - Topsoil / Organics	Oct-13	Oct-13	2862	
Friday, 4 October 2013	GAC	Zone 1	GC299397	Gate C7	Waste Skopiple	C7			Ridge Road Landfill						Ridge Road Landfill		Cut to Waste	Topsoil / Organics						46	2	38	60.8	Total volume of material disposed 274 m <sup>3</sup> (prior to 4 October no material had been disposed of). Five samples relate to Zone 1F. The current sample rate is one sample per 55 m <sup>3</sup> . This meets the minimum sampling requirements of 1 sample per 1,000 m <sup>3</sup> .	Waste Skopiple - Topsoil / Organics	Ridge Road Landfill - Cut to Waste - Topsoil / Organics	Oct-13	Oct-13	2863	
Friday, 4 October 2013	GAC	Zone 1	296574	Gate C7	Waste Skopiple	C7			Ridge Road Landfill						Ridge Road Landfill		Cut to Waste	Topsoil / Organics						36	2	38	60.8	Total volume of material disposed 274 m <sup>3</sup> (prior to 4 October no material had been disposed of). Five samples relate to Zone 1F. The current sample rate is one sample per 55 m <sup>3</sup> . This meets the minimum sampling requirements of 1 sample per 1,000 m <sup>3</sup> .	Waste Skopiple - Topsoil / Organics	Ridge Road Landfill - Cut to Waste - Topsoil / Organics	Oct-13	Oct-13	2900	
Friday, 4 October 2013	GAC	Zone 1	293939	Gate C7	Waste Skopiple	C7			Ridge Road Landfill						Ridge Road Landfill		Cut to Waste	Topsoil / Organics						46	1	19	30.4	Total volume of material disposed 274 m <sup>3</sup> (prior to 4 October no material had been disposed of). Five samples relate to Zone 1F. The current sample rate is one sample per 55 m <sup>3</sup> . This meets the minimum sampling requirements of 1 sample per 1,000 m <sup>3</sup> .	Waste Skopiple - Topsoil / Organics	Ridge Road Landfill - Cut to Waste - Topsoil / Organics	Oct-13	Oct-13	2912	
Friday, 4 October 2013	GAC	Zone 5	Area 1	Area 1	Area 1	C12		Area 3							Zone 5 - Impaired Fill		Gap 100 Spec	Permanent	30.510	6 wheeler	mech				40				Area 1 - Gap 100 Spec	Area 3 - Gap 100 Spec	Oct-13	Oct-13	2911	
Saturday, 5 October 2013	GAC	Area West	1444647		Shear Key / Undercut NW Whau				Greenmount Landfill	CA16_0-05-0-2, CA16_1-0-1-2, CA17_0-05-0-2, CA17_1-0-1-2	1175713	Clearfill	Greenmount Clearfill, Ridge Road Clearfill, (Pukekohe Island Clearfill)	Yes - CA16_0-05-0-2 had lead and nickel concentrations slightly above Auckland background ranges, though under the acceptance criteria for all three clearfill disposal sites.	Greenmount Landfill		Cut to Waste	Cut to Waste							30	30.96	49.536		Shear Key / Undercut NW Whau - Cut to Waste	Greenmount Landfill - Cut to Waste - Cut to Waste	Oct-13	Oct-13	2912	
Saturday, 5 October 2013	GAC	Area West	1444645		Shear Key / Undercut NW Whau				Greenmount Landfill						Greenmount Landfill		Cut to Waste	Cut to Waste						31.96	51.136		Shear Key / Undercut NW Whau - Cut to Waste	Greenmount Landfill - Cut to Waste - Cut to Waste	Oct-13	Oct-13	2913			
Monday, 7 October 2013	GAC	Area West	1444754		Shear Key / Undercut NW Whau				Greenmount Landfill						Greenmount Landfill		Cut to Waste	Cut to Waste																