

CAUSEWAY ALLIANCE
working for our **thriving** city

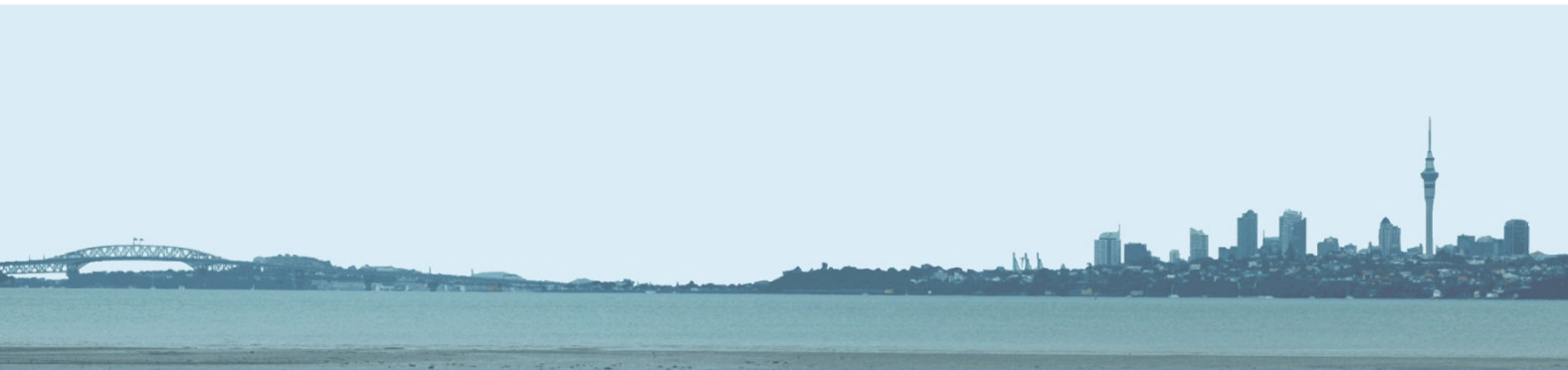

SH16 CAUSEWAY UPGRADE PROJECT



Monthly Environmental Report
November 2013

Document history and status

Revision	Date issued	Written By	Reviewed by	Approved by	Revision Status
A	18.12.2013	K Stevens	R Purdy		For REVIEW
B	19.12.13	K Stevens	M Evans	M Evans	For Approval/Release
C	20.12.13	K Stevens	M Evans	M Evans	FINAL

Distribution of copies

Revision	Purpose	Issued to
A	For review	R Purdy
B	For approval/release	M Evans
C	FINAL	Auckland Council

Printed:	14/01/2014 15:38
Last saved:	14/01/2014 15:38
File name:	K:\EN Environment\EN51 Construction\04 Council Reporting\Monthly Report\2013 11 Report\November_2013_Causeway_Upgrade_Project_Monthly_Environmental_Report_Rev_C.docx
Author:	Kevin Stevens
Environmental Manager:	Michael Cassidy
Name of organisation:	Causeway Alliance
Name of project:	SH16 Causeway Upgrade Project
Document version:	Revision C

Contents

1.0	INTRODUCTION	7
1.1	PURPOSE OF THE REPORT	7
2.0	OVERVIEW of ACTIVITIES UNDERTAKEN	7
2.1	Environmental	7
2.2	Communications and Stakeholder Management	7
2.3	Key Stakeholder Milestones	7
2.4	Construction	7
3.0	MEETINGS, INSPECTIONS & EVENTS	8
4.0	ENVIRONMENTAL MONITORING	8
4.1	EARTHWORKS COMPLIANCE	8
4.2	CONSTRUCTION NOISE & VIBRATION	8
4.3	AIR QUALITY	9
4.4	CONTAMINATED SOIL	9
4.5	EROSION AND SEDIMENT CONTROL	9
4.6	ARCHAEOLOGICAL	9
4.7	COASTAL MONITORING	9
4.8	MARINE MONITORING	10
4.9	ECOLOGICAL	10
5.0	CORRESPONDENCE ON CONSENT CONDITIONS AND PLANS	10
6.0	WORKS PROPOSED FOR DECEMBER 2013	10

Appendix A: SH16 Causeway Alliance Construction Zone Plan

Appendix B: SH16 Causeway Imported and Exported Material Summary

1.0 INTRODUCTION

1.1 PURPOSE OF THE REPORT

To provide Auckland Council with a monthly overview of construction progress and compliance activity on the SH16 Causeway Upgrade project.

This report describes and details activities during the month of November 2013.

2.0 OVERVIEW of ACTIVITIES UNDERTAKEN

2.1 Environmental

Regular contact is continuing with the Auckland Council compliance team.

Submitted the resource consent application for the new Rosebank Domain access improvements (for works outside the designation).

2.2 Communications and Stakeholder Management

The quarterly Community Liaison Group (CLG) meeting was held on 13 November to an audience of approximately 50 local residents and stakeholders. This was a joint CLG meeting with the Te Atatu Interchange Upgrade project.

One resident from Waterview complained about a reversing beeper and rock unloading at 6.30am during the week. We have checked to confirm that we are operating within the permitted noise limits and responded to the resident.

2.3 Key Stakeholder Milestones

- Produced fortnightly Causeway News project updates to stakeholders, project neighbours and wider community
- Conducting an on-line shared path users' survey with cyclists and pedestrians.
- Iwi blessing for lizard release in Harbourview-Orangihina on the Te Atatu Peninsula.

Positive feedback was received from residents and local stakeholders.

2.4 Construction

- Alwyn Ave - earthworks completed for access down to Whau River Bridge abutment (south-west side). Mangrove clearance and ground improvements in the marine area underway.
- Whau River Bridge (north-west) – ground improvements and revetment rock installation under existing bridge. Installation of temporary staging underway.

- Whau River Bridge (north-east) - installation of temporary staging completed and permanent piling will start in early December.
- Rosebank Park Domain – barriers established and site clearance continued.
- Causeway (from North Traherne Island in an easterly direction) – continue installing drainage layer, wick drains, ground monitoring instrumentation and advancing the coffer dam and working platform in the Coastal Marine Area. Continue installation of the preload fill layer up to full height.
- Causeway (South Traherne Island) – earthworks for the working platform, drainage layer continuing (either side of South Traherne Island) and wick drain installation underway.
- Great North Road Interchange (GNRI) (northern side, eastbound from Causeway Bridge) – earthworks commenced in preparation for wick drain installation. Continue advancing the coffer dam and reclamation.
- GNRI (southern side, westbound towards Causeway Bridge) – continue earthworks for raising the area and establishing the shared path (with utilities trench) in the final (permanent) location. Continue ground investigations to establish extent of basalt layer

3.0 MEETINGS, INSPECTIONS & EVENTS

6 November – Met with two Council elected representatives at the Rosebank timber boardwalk site, to discuss a revised fill embankment (reclamation) design and the planning process for approval of the design.

14 November – Council’s earthworks Compliance inspection

15 November – Council’s coastal compliance inspection

28 November – Council site inspection of coffer dam slump at Causeway Bridge

4.0 ENVIRONMENTAL MONITORING

4.1 EARTHWORKS COMPLIANCE

Compliance Inspection was completed by Auckland Council officers on the 14 November and recorded a compliance score of 1 (Full Compliance).

4.2 CONSTRUCTION NOISE & VIBRATION

There were no Site Specific Noise Management Plans submitted or approved in November.

In accordance with BoI Condition ON.9 the residents at 38 and 40 Alwyn Avenue (who overlook the Whau Bridge) were advised of the proposed acoustic building modification options to their

houses to enable compliance with Board of Inquiry's allowable operational noise limits. The residents have three months to confirm agreement with the proposed modifications.

Residents at 42 and 44 Alwyn Avenue were advised that the predicted noise levels in their houses would remain below the allowable limit and therefore no building modification is required.

4.3 AIR QUALITY

No air quality complaints or issues were received during the period, or were recorded on Causeway Alliance Daily Site Reports. A water truck is regularly watering metal construction roads and work sites to minimise dust nuisance.

4.4 CONTAMINATED SOIL

A summary of imported material sources and exported material disposal locations, classifications sample methods and quantities at various site locations during November is included in Appendix B.

4.5 EROSION AND SEDIMENT CONTROL

There were no site specific Erosion and Sediment Control Plans submitted or approved in November.

4.6 ARCHAEOLOGICAL

An inspection of a recorded midden site in the Rosebank – Patiki section was undertaken on 18 November.

Two site visits with stonemasons to scope the extent of repairs possible to the dry stone wall at GNRI to comply with BoI Condition ARCH.7(c).

4.7 COASTAL MONITORING

Compliance Inspection was completed by Auckland Council officers on the 15 November and recorded a compliance score of 2B (minor non-compliance with consent conditions). This related to works on the eastbound off-ramp site at GNRI where coastal rock salvaged from the existing embankment was being used to line the temporary stability berm. During these operations, fines attached to the rock and transferred during the works were at risk of generating sedimentation to the coastal environment. This was the first score below 1 since coastal works commenced in May 2014.

4.8 MARINE MONITORING

No marine monitoring was undertaken during the period.

On 28 and 29 November the leading coffer dam face at the eastern GNRI (north) site slumped toward the main drainage channel near the Causeway Bridge. The slumped area is approximately 30m long and is being regularly monitored by the Alliance. No further movement has been detected through daily survey monitoring. A hydrographical survey will be undertaken to map the slump and an assessment undertaken to determine the cause of the instability and whether there has been any effect on the channel. A further review will be held with Council staff in December.

4.9 ECOLOGICAL

Three inspections of Significant and Valued vegetation were undertaken on 20 November at both North and South Traherne Island, Whau River Bridge and at GNRI.

The area of vegetation over-clearance on south-west Traherne Island was replanted with approximately 175 plants in early November, following finalisation of the replanting plan. The plants were sourced from seedlings obtained from Traherne Island. The new plants are growing well and have been monitored by the Project Botanist.

Monthly assessment of avian roosting locations was undertaken in Zone 3 (Harbourview-Orangihina). The monthly avian count for November was 11 birds compared to the pre-establishment baseline count in November 2010 of 14 birds.

Two temporary bird roost sites (floating pontoons) were installed south of Causeway Bridge.

5.0 CORRESPONDENCE ON CONSENT CONDITIONS AND PLANS

There were no items in November.

6.0 WORKS PROPOSED FOR DECEMBER 2013

Refer Appendix A for Construction Zone Plan.

Zone 1 Causeway

- Continue installing the working platform, preload fill (surcharge), drainage blanket layer, wick drains, coffer dam and reclamation in the coastal area on both sides of the Causeway and Traherne Island.
- Survey coastal transects on the northern side of Causeway.

Zone 2 / Zone 3 Whau to Rosebank

- Whau River eastbound: complete installation of temporary staging units on the north-east side of Whau River Bridge and commence piling for widening Whau Bridge. Continue installing staging and rock protection under Whau River Bridge (north-west abutment).

- Patiki/Rosebank eastbound: continue earthworks, establish access and commence piling for retaining wall.
- Whau River westbound: continue ground improvements in marine area (excavate soft material and replace with compacted metal), for south-west abutment below Alwyn Avenue.
- Rosebank/Patiki westbound: establish shared path diversion from Patiki overbridge to Whau Bridge (around Rosebank Park Domain) to relocate cycleway into bus shoulder.

Zone 5 GNRI

- East bound: continue earthworks to widen the embankment in an easterly direction alongside Great North Road east-bound off-ramp. Investigate impact of coffer dam slump and review design by Causeway Bridge. Vegetation clearance adjacent to stone wall within consented footprint.
- Westbound: complete utilities trench and paving for 400m length of permanent cycleway. Continue filling embankment area (where cyclists have been moved to old bus shoulder lane).

The environmental focus for December will continue to be on inspections prior to and during vegetation removal and ground clearance to ensure ecological and archaeological stand over requirements are met. The establishment and monitoring of sediment and erosion controls will also continue.

Appendix A: SH16 Causeway Alliance Construction Zone Plan

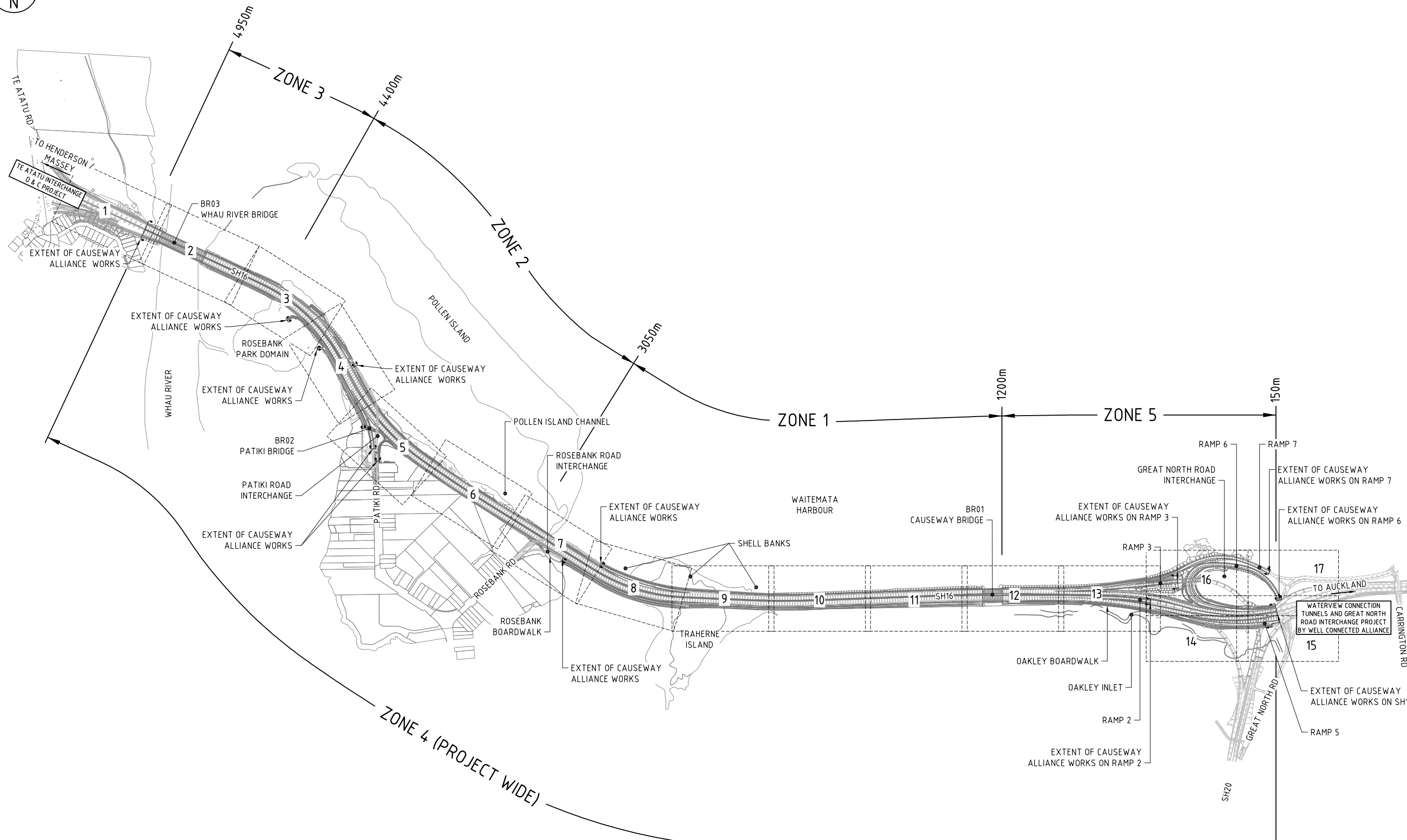

TE ATATU INTERCHANGE
D & C PROJECT

TO HENDERSON /
MASSEY

EXTENT OF CAUSEWAY
ALLIANCE WORKS

BR03
WHAU RIVER BRIDGE

EXTENT OF CAUSEWAY
ALLIANCE WORKS

ROSEBANK
PARK DOMAIN

EXTENT OF CAUSEWAY
ALLIANCE WORKS

WHAU RIVER

BR02
PATIKI BRIDGE

PATIKI ROAD
INTERCHANGE

EXTENT OF CAUSEWAY
ALLIANCE WORKS

ZONE 4 (PROJECT WIDE)

ZONE 3

4950m

4400m

ZONE 2

3050m

ZONE 1

1200m

ZONE 5

150m

1

2

3

4

5

6

7

8

9

10

11

12

13

14

15

16

17

SH16

POLLEN ISLAND

POLLEN ISLAND CHANNEL

ROSEBANK ROAD
INTERCHANGE

WAITEMATA
HARBOUR

BR01
CAUSEWAY BRIDGE

EXTENT OF CAUSEWAY
ALLIANCE WORKS ON RAMP 3

GREAT NORTH ROAD
INTERCHANGE

RAMP 6

RAMP 7

EXTENT OF CAUSEWAY
ALLIANCE WORKS ON RAMP 7

EXTENT OF CAUSEWAY
ALLIANCE WORKS ON RAMP 6

EXTENT OF CAUSEWAY
ALLIANCE WORKS

SHELL BANKS

ROSEBANK RD

EXTENT OF CAUSEWAY
ALLIANCE WORKS

TRAHERNE
ISLAND

OAKLEY BOARDWALK

OAKLEY INLET

RAMP 2

EXTENT OF CAUSEWAY
ALLIANCE WORKS ON RAMP 2

RAMP 3

EXTENT OF CAUSEWAY
ALLIANCE WORKS ON RAMP 3

RAMP 3

RAMP 5

WATERVIEW CONNECTION
TUNNELS AND GREAT NORTH
ROAD INTERCHANGE PROJECT
BY WELL CONNECTED ALLIANCE

EXTENT OF CAUSEWAY
ALLIANCE WORKS ON SH16

RAMP 5

TO AUCKLAND

CARRINGTON RD

SH20

GREAT NORTH RD

Appendix B: SH16 Causeway Imported and Exported Material Summary

Date	Transport Subcontractor	Ordering Zone	Docket #	Material Source Import Only	From Area Non-Import Only	Gate	From Description Non-Import Only	From Chainage	To Area	Sample ID	Lab Report ID	Classification	Acceptable Disposal Facility	Conformance	To Description	To Chainage	Specification Description on Fill Only	Material Type	Type of work	Truck Type	Load Count	Truck Volume (T)	Total Volume (T)	Total Volume (m ³) (conversion factor of 1.6 (1 t = 1.6 m ³))	Sample Rate
11/11/2013	G&C	Area West	68400	Site	West - Gate C3		Topsoil / organics Stockpile		Ridge Road Landfill						Landfill		Cut to Waste	Clean Fill	Artic		1	20	20		
11/11/2013	G&C	Area West	68399	Site	West - Gate C3		Topsoil / organics Stockpile		Ridge Road Landfill						Landfill		Cut to Waste	Clean Fill	Artic		1	20	20		
11/11/2013	G&C	Area West	68405	Site	West - Gate C3		Topsoil / organics Stockpile		Ridge Road Landfill						Landfill		Cut to Waste	Clean Fill	Artic		1	20	20	66.25	No sampling undertaken
11/11/2013	G&C	Zone 2	68445	Site	West - Gate C3	C3	Topsoil / organics Stockpile		Ridge Road Landfill						Landfill		Cut to Waste	Clean Fill	Truck & Trailer		1	20	20		
12/11/2013	G&C	Area West	68489	Site	West - Gate C3		Topsoil / organics Stockpile		Ridge Road Landfill						Landfill		Cut to Waste	Clean Fill	Artic		1	30	30		
12/11/2013	G&C	Area West	68444	Site	West - Gate C3		Topsoil / organics Stockpile		Ridge Road Landfill						Landfill		Cut to Waste	Clean Fill	Artic		1	20	20		
12/11/2013	G&C	Area West	68445	Site	West - Gate C3		Topsoil / organics Stockpile		Ridge Road Landfill						Landfill		Cut to Waste	Clean Fill	Artic		1	20	20		
12/11/2013	G&C	Area West	68499	Site	West - Gate C3		Topsoil / organics Stockpile		Ridge Road Landfill						Landfill		Cut to Waste	Clean Fill	Artic		1	20	20		
12/11/2013	G&C	Area West	68500	Site	West - Gate C3		Topsoil / organics Stockpile		Ridge Road Landfill						Landfill		Cut to Waste	Clean Fill	Artic		1	20	20		
12/11/2013	G&C	Area West	68498	Site	West - Gate C3		Topsoil / organics Stockpile		Ridge Road Landfill						Landfill		Cut to Waste	Clean Fill	Artic		1	20	20	150	No sampling undertaken
12/11/2013	G&C	Area West	68442	Site	West - Gate C3		Topsoil / organics Stockpile		Ridge Road Landfill						Landfill		Cut to Waste	Clean Fill	Artic		1	20	20		
12/11/2013	G&C	Area West	68540	Site	West - Gate C3		Topsoil strip		Ridge Road Landfill						Landfill		Cut to Waste	Topsoil / Unsuitable	Artic		1	20	20		
12/11/2013	G&C	Area West	68444	Site	West - Gate C3		Topsoil strip		Ridge Road Landfill						Landfill		Cut to Waste	Topsoil / Unsuitable	Artic		1	20	20		
12/11/2013	G&C	Area West	68489	Site	West - Gate C3		Topsoil strip		Ridge Road Landfill						Landfill		Cut to Waste	Topsoil / Unsuitable	Artic		1	20	20		
12/11/2013	G&C	Area West	68599	Site	West - Gate C3		Topsoil strip		Ridge Road Landfill						Landfill		Cut to Waste	Topsoil / Unsuitable	Artic		1	20	20		
12/11/2013	G&C	Area West	68639	Site	West - Gate C3		Topsoil strip		Ridge Road Landfill						Landfill		Cut to Waste	Topsoil / Unsuitable	Artic		1	20	20		
13/11/2013	G&C	Area West	68622	Site	West - Gate C3		Topsoil / organics Stockpile		Ridge Road Landfill						Landfill		Cut to Waste	Clean Fill	Artic		1	20	20		
13/11/2013	G&C	Area West	68605	Site	West - Gate C3		Topsoil / organics Stockpile		Ridge Road Landfill						Landfill		Cut to Waste	Clean Fill	Artic		1	20	20		
13/11/2013	G&C	Area West	68556	Site	West - Gate C3		Topsoil / organics Stockpile		Ridge Road Landfill						Landfill		Cut to Waste	Clean Fill	Artic		1	20	20		
13/11/2013	G&C	Area West	68591	Site	West - Gate C3		Topsoil / organics Stockpile		Ridge Road Landfill						Landfill		Cut to Waste	Clean Fill	Artic		1	20	20		
13/11/2013	G&C	Area West	68557	Site	West - Gate C3		Topsoil / organics Stockpile		Ridge Road Landfill						Landfill		Cut to Waste	Clean Fill	Artic		1	20	20		
13/11/2013	G&C	Area West	68594	Site	West - Gate C3		Topsoil / organics Stockpile		Ridge Road Landfill						Landfill		Cut to Waste	Clean Fill	Artic		1	20	20		
13/11/2013	G&C	Area West	68536	Site	West - Gate C3		Topsoil / organics Stockpile		Ridge Road Landfill						Landfill		Cut to Waste	Clean Fill	Artic		1	20	20		
13/11/2013	G&C	Area West	68487	Site	West - Gate C3		Topsoil / organics Stockpile		Ridge Road Landfill						Landfill		Cut to Waste	Clean Fill	Artic		1	20	20		
13/11/2013	G&C	Area West	68595	Site	West - Gate C3		Topsoil / organics Stockpile		Ridge Road Landfill						Landfill		Cut to Waste	Clean Fill	Artic		1	20	20		
14/11/2013	G&C	Area West	68642	Site	West - Gate C3		Topsoil / organics Stockpile		Ridge Road Landfill						Landfill		Cut to Waste	Clean Fill	Artic		1	20	20		
14/11/2013	G&C	Area West	68633	Site	West - Gate C3		Topsoil / organics Stockpile		Ridge Road Landfill						Landfill		Cut to Waste	Clean Fill	Artic		1	20	20	25	No sampling undertaken
15/11/2013	G&C	Zone 2	68928	Site	West - Gate C3	C3	Topsoil / organics Stockpile		Ridge Road Landfill						Landfill		Cut to Waste	Clean Fill	Truck & Trailer		1	30	30		
15/11/2013	G&C	Zone 2	68901	Site	West - Gate C3	C3	Topsoil / organics Stockpile		Ridge Road Landfill						Landfill		Cut to Waste	Clean Fill	Truck & Trailer		1	30	30		
15/11/2013	G&C	Zone 2	68914	Site	West - Gate C3	C3	Topsoil / organics Stockpile		Ridge Road Landfill						Landfill		Cut to Waste	Clean Fill	Truck & Trailer		1	30	30		
15/11/2013	G&C	Zone 2	68928	Site	West - Gate C3	C3	Topsoil / organics Stockpile		Ridge Road Landfill						Landfill		Cut to Waste	Clean Fill	Truck & Trailer		1	30	30	75	No sampling undertaken
15/11/2013	G&C	Zone 1	68791	Site	Zone 1C	C5			Ridge Road Landfill	CA31; CA32	1182532	Cleanfill/Managed Fill	Greenmount Cleanfill, Ridge Road Managed, Greenmount Managed, Hampton Downs	Yes - Taken to Ridge Road Managed Landfill. CA31 had nickel concentrations slightly above Auckland background ranges. CA32 had copper, lead and nickel concentrations slightly above Auckland background ranges. Metal concentrations were under the acceptance criteria for all three cleanfill sites. CA32 had Benz[a]pyrene (BAP) concentrations that exceeded the Ridge Road cleanfill acceptance criteria, though these were under the Greenmount B(a)P Equivalent acceptance criteria.	Landfill		Cut to Waste	Topsoil / Organics	Truck & Trailer				29.5	18.4	Total volume of material disposed 53 m ³ (includes 35 m ³ already disposed of in October). Two samples relate to Zone 1C. The current sample rate is one sample per 27 m ³ . This meets the minimum sampling requirements of 1 sample per 500 m ³ for managed fill.
15/11/2013	G&C	Zone 1	68790	Site	Zone 1C	C5			Ridge Road Landfill	CA31; CA32	1182532	Cleanfill/Managed Fill	Greenmount Cleanfill, Ridge Road Managed, Greenmount Managed, Hampton Downs	Yes - Taken to Ridge Road Managed Landfill. CA31 had nickel concentrations slightly above Auckland background ranges. CA32 had copper, lead and nickel concentrations slightly above Auckland background ranges. Metal concentrations were under the acceptance criteria for all three cleanfill sites. CA32 had Benz[a]pyrene (BAP) concentrations that exceeded the Ridge Road cleanfill acceptance criteria, though these were under the Greenmount B(a)P Equivalent acceptance criteria.	Landfill		Cut to Waste	Topsoil / Organics	Artic				29.5	36.9	Total volume of material disposed 90 m ³ (includes 53 m ³ already disposed of in October/November). Two samples relate to Zone 1C. The current sample rate is one sample per 45 m ³ . This meets the minimum sampling requirements of 1 sample per 500 m ³ for managed fill.
15/11/2013	G&C	Zone 1	68789	Site	Zone 1C	C5			Ridge Road Landfill					Landfill		Cut to Waste	Topsoil / Organics	Truck & Trailer					29.5	25	No sampling undertaken
16/11/2013	G&C	Area West	68925	Site	West - Gate C3		Topsoil / organics Stockpile		Ridge Road Landfill						Landfill		Cut to Waste	Clean Fill	Artic		1	20	20		
16/11/2013	G&C	Area West	68916	Site	West - Gate C3		Topsoil / organics Stockpile		Ridge Road Landfill						Landfill		Cut to Waste	Clean Fill	Truck & Trailer		1	30	30		
16/11/2013	G&C	Area West	68901	Site	West - Gate C3	C3	Topsoil / organics Stockpile		Ridge Road Landfill						Landfill		Cut to Waste	Topsoil / Unsuitable	Truck & Trailer		1	30	30		
18/11/2013	G&C	Area West	68981	Site	West - Gate C3		Topsoil strip		Ridge Road Landfill						Landfill		Cut to Waste	Topsoil / Unsuitable	Truck & Trailer		1	30	30		
18/11/2013	G&C	Area West	69034	Site	West - Gate C3		Topsoil strip		Ridge Road Landfill						Landfill		Cut to Waste	Topsoil / Unsuitable	Truck & Trailer		1	30	30		
18/11/2013	G&C	Area West	68987	Site	West - Gate C3		Topsoil strip		Ridge Road Landfill						Landfill		Cut to Waste	Topsoil / Unsuitable	Truck & Trailer		1	30	30		
18/11/2013	G&C	Area West	68944	Site	West - Gate C3		Topsoil strip		Ridge Road Landfill						Landfill		Cut to Waste	Topsoil / Unsuitable	Truck & Trailer		1	30	30		
18/11/2013	G&C	Area West	68949	Site	West - Gate C3		Topsoil / organics Stockpile		Ridge Road Landfill						Landfill		Cut to Waste	Clean Fill	Truck & Trailer		1	30	30		
18/11/2013	G&C	Zone 2	68948	Site	West - Gate C3	C3	Topsoil / organics Stockpile		Ridge Road Landfill						Landfill		Cut to Waste	Clean Fill	Truck & Trailer		1	30	30		
18/11/2013	G&C	Zone 2	69039	Site	West - Gate C3	C3	Topsoil / organics Stockpile		Ridge Road Landfill						Landfill		Cut to Waste	Clean Fill	Truck & Trailer		1	30	30		
18/11/2013	G&C	Zone 2	68987	Site	West - Gate C3	C3	Topsoil / organics Stockpile		Ridge Road Landfill						Landfill		Cut to Waste	Clean Fill	Truck & Trailer		1	30	30		
18/11/2013	G&C	Zone 2	68948	Site	West - Gate C3	C3	Topsoil / organics Stockpile		Ridge Road Landfill						Landfill		Cut to Waste	Clean Fill	Truck & Trailer		1	30	30		
18/11/2013	G&C	Zone 3	69003	Site	West - Gate C3	C3	Topsoil / organics Stockpile		Ridge Road Landfill						Landfill		Cut to waste	Cut to Waste	Truck & Trailer		1	30	29		
19/11/2013	G&C	Zone 2	69110	Site	West - Gate C3	C3	Topsoil / organics Stockpile		Ridge Road Landfill						Landfill		Cut to Waste	Clean Fill	Truck & Trailer		1	30	29		
19/11/2013	G&C	Zone 2	69073	Site	West - Gate C3	C3	Topsoil / organics Stockpile		Ridge Road Landfill						Landfill		Cut to Waste	Clean Fill	Truck & Trailer		1	30	29		
19/11/2013	G&C	Zone 2	69100	Site	West - Gate C3	C3	Topsoil / organics Stockpile		Ridge Road Landfill						Landfill		Cut to Waste	Clean Fill	Truck & Trailer		1	30	29		
19/11/2013	G&C	Zone 2	69082	Site	West - Gate C3	C3	Topsoil / organics Stockpile		Ridge Road Landfill						Landfill		Cut to Waste	Clean Fill	Truck & Trailer		1	30	29		
20/11/2013	G&C	Zone 3	69166	Site	West - Gate C3	C3	Topsoil / organics Stockpile		Ridge Road Landfill						Cut to waste		Cut to Waste	Cut to Waste	Truck & Trailer		1	30	29		
20/11/2013	G&C	Zone 3	69141	Site	West - Gate C3	C3	Topsoil / organics Stockpile		Ridge Road Landfill						Cut to waste		Cut to Waste	Cut to Waste	Truck & Trailer		1	30	29		
22/11/2013	G&C	Zone 3		Site	Alwyn Ave		Cut to waste		Alwyn Ave						Cut to waste		Cut to Waste	Clean Fill	6 Wheeler		5	8	40	25	No sampling undertaken
23/11/2013	G&C	Zone 1	69400	Site	Zone 1C	C5			Ridge Road Landfill	CA31; CA32	1182532	Cleanfill/Managed Fill	Greenmount Cleanfill, Ridge Road Managed, Greenmount Managed, Hampton Downs	Yes - Taken to Ridge Road Managed Landfill. CA31 had nickel concentrations slightly above Auckland background ranges. CA32 had copper, lead and nickel concentrations slightly above Auckland background ranges. Metal concentrations were under the acceptance criteria for all three cleanfill sites. CA32 had Benz[a]pyrene (BAP) concentrations that exceeded the Ridge Road cleanfill acceptance criteria, though these were under the Greenmount B(a)P Equivalent acceptance criteria.	Landfill		Cut to Waste	Topsoil / Organics	Truck & Trailer				28.8	18	Total volume of material disposed 108 m ³ (includes 90 m ³ already disposed of in October/November). Two samples relate to Zone 1C. The current sample rate is one sample per 54 m ³ . This meets the minimum sampling requirements of 1 sample per 500 m ³ for managed fill.
25/11/20																									

30/11/2013	G&C	Zone 3		Site	ear Key / Undercut SW Whau	Shear Key / Undercut		Alwyn Ave	CA33; CA34	1182532	Cleanfill	Greenmount Cleanfill, Ridge Road Cleanfill, (Puketutu Island Cleanfill)	Kept Onsite	Stockpile	Cut to Waste	Cut to Waste		6 wheeler	6		48	30	Total volume of material disposed 185 m ³ (includes 155 m ³ already disposed of in November). Two samples relate to SW Whau. The current sample rate is one sample per 93 m ³ . This meets the minimum sampling requirements of 1 sample per 1,000 m ³ for cleanfill.
------------	-----	--------	--	------	----------------------------	----------------------	--	-----------	------------	---------	-----------	---	-------------	-----------	--------------	--------------	--	-----------	---	--	----	----	---