

CAUSEWAY ALLIANCE
working for our **thriving** city



SH16 CAUSEWAY UPGRADE PROJECT



Monthly Environmental Report

June 2014

Document history and status

Revision	Date issued	Written By	Reviewed by	Approved by	Revision Status
A	1 August 2014	R Purdy	S Price, S Paton	B Dunbar	Final

Distribution of copies

Revision	Purpose	Issued to
A	Final June Environmental Report	Auckland Council

Printed:	01/07/2014
Last saved:	01/08/2014 15:29
File name:	K:\EN Environment\EN51 Construction\04 Council Reporting\Monthly Report\2014 Environmental Reports\2014 04 Report \ June_2014_Causeway_Upgrade_Project_Monthly_Environmental_Report_Rev_A .docx
Author:	Rachel Purdy
Environmental Manager:	Steve Jenkins
Name of organisation:	Causeway Alliance
Name of project:	SH16 Causeway Upgrade Project
Document version:	Revision A

Contents

1.0	INTRODUCTION	7
1.1	PURPOSE OF THE REPORT	7
2.0	OVERVIEW OF ACTIVITIES UNDERTAKEN	7
2.1	Environmental	7
2.2	Communications and Stakeholder Management	7
2.3	Construction	8
3.0	MEETINGS, INSPECTIONS AND EVENTS	9
4.0	ENVIRONMENTAL MONITORING	9
4.1	EARTHWORKS COMPLIANCE	9
4.2	CONSTRUCTION NOISE AND VIBRATION	9
4.3	AIR QUALITY	9
4.4	CONTAMINATED SOIL	9
4.5	EROSION AND SEDIMENT CONTROL	9
4.6	ARCHAEOLOGICAL	9
4.7	COASTAL MONITORING	9
4.8	MARINE MONITORING	10
4.9	ECOLOGICAL	10
5.0	CORRESPONDENCE ON CONSENT CONDITIONS AND PLANS	10
6.0	WORKS PROPOSED FOR JULY, AUGUST AND SEPTEMBER 2014	11
	APPENDIX A – SH16 CAUSEWAY UPGRADE PROJECT IMPORTED AND EXPORTED MATERIALS SUMMARY	12
	Appendix B – SH16 CAUSEWAY UPGRADE PROJECT CONSTRUCTION ZONES PLAN	13

-

1.0 INTRODUCTION

1.1 PURPOSE OF THE REPORT

To provide Auckland Council with a monthly overview of construction progress and compliance activity on the SH16 Causeway Upgrade Project.

This report describes and details activities that took place during the month of June 2014.

2.0 OVERVIEW OF ACTIVITIES UNDERTAKEN

2.1 Environmental

Regular contact is continuing with the Auckland Council compliance team.

2.2 Communications and Stakeholder Management

- Produced monthly Causeway News project updates to stakeholders, project neighbours and wider community.
- Completed the precondition survey process for commercial businesses adjacent to the project in the Rosebank area.
- Visited Waterview residents whose properties overlook the project and who requested schedules of noisy activities, such as piling, so they can roster their working from home commitments around these activities.
- Hosted Rutherford Primary school team lead and teachers as part of our Education Liaison Group.
- Received feedback from a cyclist that they have observed people fishing from the Whau River Bridge cycleway. This has been discussed with Auckland Transport and a request lodged to install no fishing signs on the bridge.
- Received a suggestion from a member of the public regarding construction of an additional bridge over the Whau River. The extensive design, planning and consultation process associated with the project was explained and Auckland Transport's number provided as we understand an additional bridge was investigated some years ago.
- Received feedback from one commercial driver regarding the lane width being too narrow for trucks in some places along SH16. The driver was advised that the lanes comply with the NZ Transport Agency standard of 3.25m in width, and in a few places are 3.1m (which is the same as the permanent marking on the Auckland Harbour Bridge). These widths are deemed sufficient with the lowered speed limit of 80kph.
- Received queries from two drivers wishing to confirm the speed limit on sections of SH16 at certain dates. For the dates provided and the areas confirmed, the speed limit was 70kph at the time.

- Continued discussions with Auckland Council regarding the Rosebank Park Domain Open Space Restoration Plan and met with the Auckland Council Parks, Sport and Recreation Officer (West) and Whau Local Board representative on-site in late June.
- Continued discussions with Iwi on 'art in design' concepts and features along the new northwestern cycleway at six locations identified in the SH16 Causeway Upgrade Project Urban Design and Landscape Plan.
- Received a response from the Department of Conservation in relation to the two embankment build outs adjacent to the new northwestern cycleway and proposed access points to northern Traherne Island and Whau River as substitute scope for the previously proposed South Traherne Island boardwalk.

2.3 Construction

- Whau River Bridge (northern side) – installation of beams for 75% of the bridge spans complete.
- Whau River Bridge (southern side) - piling for the westbound spans at the south west abutment complete.
- Patiki to Whau (westbound, around Rosebank Park Domain) – earthworks along Rosebank Park Domain batter slope remain on hold following the detection of asbestos, earthworks and preloading for the reclamation of the Coastal Marine Area (CMA) around the raceway channel complete. Embankment filling west of Rosebank Park Domain underway. Ground improvements at the Patiki on-ramp underway.
- Whau to Rosebank (eastbound) – earthworks and rock revetment continuing – at various stages along this section of works. Mechanically Stabilised Earth wall construction complete and filling is occurring west of the wall.
- Causeway (from North Traherne Island eastbound) – continue installation of the preload fill layer (surcharge) up to full height and coffer dam/stability – this is at various stages along the embankment. Preloading to the bridge transitions at either side of the new Causeway Bridge commenced following completion of piling at north-west abutment. Preload and embankment fill at North Traherne Island complete. Remedial works required to embankment slumps before further earthworks proceed in these areas.
- Causeway (South Traherne Island, westbound) – vegetation clearance complete. Continue installation of the preload fill layer up to full height – this is at various stages along the westbound side of SH16.
- Great North Road Interchange (GNRI) (northern side, eastbound from Causeway Bridge) – installation of preload adjacent to the GNR eastbound on-ramp commenced, excavation of eastbound on-ramp complete to subgrade level. Pile installation underway at Causeway Bridge north-western abutment complete. Preload further east of Causeway Bridge continuing.

- GNRI (southern side, westbound towards Causeway Bridge) – continue earthworks and utility trenching, timber piling at Oakley Creek basalt transition and preload on top of the timber piles complete. Installation of steel piles in slip area underway. Oakley Creek boardwalk piling underway.

3.0 MEETINGS, INSPECTIONS AND EVENTS

5 and 19 June (2 visits) – Auckland Council’s earthworks compliance inspections.

19 June – Auckland Council’s coastal compliance inspection.

4.0 ENVIRONMENTAL MONITORING

4.1 EARTHWORKS COMPLIANCE

Compliance Inspections were completed by Auckland Council officers on 5 and 19 June and recorded a compliance score of 1 (Full Compliance).

4.2 CONSTRUCTION NOISE AND VIBRATION

No Site Specific Noise Management Plans were submitted and approved in June.

4.3 AIR QUALITY

No air quality complaints or issues were received during June.

4.4 CONTAMINATED SOIL

A summary of exported material disposal locations, along with material classifications, sample methods and quantities at various site locations along the alignment during June is included in Appendix A.

Earthworks at the Rosebank Park Domain embankment remain on hold following the detection and sampling of asbestos material found in the embankment. Discussions with Auckland Council’s contaminated soil specialist in relation to disposal and further activities are continuing.

4.5 EROSION AND SEDIMENT CONTROL

No site specific Erosion and Sediment Control Plans were submitted or approved by Auckland Council in June.

4.6 ARCHAEOLOGICAL

No archaeological inspections were undertaken in June.

4.7 COASTAL MONITORING

A coastal compliance inspection was completed by Auckland Council officers on the 19 June and recorded a compliance score of 1.

The stabilisation and remediation of the Oakley Creek slump is being undertaken in accordance with the methodology agreed with Council. The installation of timber piles overlaying the area of basalt in the Creek and the placement of preload over the piles is complete, allowing settlement to commence. The steel piled grid is partially complete.

The further slips which occurred on the northern side of the Causeway works on 11 March and 2 April continue to be monitored. Pile installation at the Causeway Bridge north-western abutment, to provide stability to this slip area, is complete.

4.8 MARINE MONITORING

The winter 2014 marine benthic habitat monitoring will be undertaken during July and August 2014.

4.9 ECOLOGICAL

No inspections of Significant and Valued vegetation were undertaken during June (refer to Section 5.0 in relation to confirmation from Auckland Council that fortnightly inspections are no longer required).

No assessment of avian roosting locations at Harbourview-Orangihina (Pony Club) and the temporary roosting rafts at the Causeway Bridge was undertaken in June (refer to Section 5.0 in relation to confirmation from Auckland Council that the monthly inspections are no longer required).

5.0 CORRESPONDENCE ON CONSENT CONDITIONS AND PLANS

Auckland Council has confirmed that monthly Avian counts at Harbourview–Orangihina and the temporary bird roost structures located to the south of the Causeway Bridge (required by Board of Inquiry (BoI) Avian Condition A.3), can cease as of June 2014. Avian counts in these areas undertaken since April 2013 indicate that the numbers of birds roosting at Harbourview Orangihina and in the general Causeway Bridge area are consistent with counts undertaken prior to the commencement construction. The project construction works are not resulting in the displacement of roosting birds.

Auckland Council has confirmed that fortnightly vegetation monitoring can cease as of June 2014. This is due to vegetation clearance being largely complete with remaining vegetation located behind silt fences or complete rock revetments. Future vegetation inspections will be in response to a specific request from the Alliance and/or an annual inspection of the replanted areas at Traherne Island.

Approval of the permanent stormwater design for Zones 1, 2, 3 and 5 received from Auckland Council in accordance with BoI Stormwater Condition SW.12.

Dispensation under the Auckland City Consolidated Bylaw Part 27 - Signs granted by Auckland Council for a single sided replacement advertising sign for the motorsport clubs at the Rosebank Park Domain.

6.0 WORKS PROPOSED FOR JULY, AUGUST AND SEPTEMBER 2014

Zone 1 Causeway

- Eastbound: Complete preload at Causeway Bridge transitions. Continue preload fill (surcharge) at westbound locations where this is not yet complete. Stabilise western most slip area with timber piles to allow further earthworks to proceed in these areas.
- Westbound: Divert cycleway onto closed bus lane westbound from Causeway Bridge to Traherne Island South, complete earthworks and preload at Traherne Island South (and towards Rosebank Road off-ramp). Earthworks and culvert works under Rosebank Road westbound off-ramp.

Zone 2 / Zone 3 Whau to Rosebank

- Eastbound: Continue installing new Whau Bridge spans (four left to install). Continue earthworks and rock revetment in this area and complete earthworks on east-bound shoulder east of Whau River Bridge, including treatment swale.
- Westbound: Continue temporary and permanent piling for Whau Bridge widening, commence Whau River Bridge south-west abutment crossheads. Continue earthworks between Whau River Bridge and Patiki Road. Complete asbestos removal and earthworks at Rosebank Park Domain batter. Continue ground improvements for Patiki Road on-ramp widening/underpass. Undertake temporary diversion of the existing Patiki on-ramp to allow access for piling of the new on-ramp and commence piling.

Zone 5 GNRI

- East bound: Continue preload alongside Great North Road eastbound off-ramp and commence some drainage and pavement works, stabilise subgrade and realign existing services in Area 10 (new eastbound on-ramp).
- Westbound: Complete installation of piles in Oakley Creek slip area and continue embankment filling. Along eastbound on-ramp. Continue Oakley Creek boardwalk piling.

Refer Appendix B for Construction Zone Plan showing the zones referred to above.

The environmental focus for July will focus on disposal of asbestos found in the Rosebank Park Domain embankment so earthworks can commence. We will continue to focus on monitoring material movements within the project, monitoring of erosion and sediment controls and monitoring remedial works in Oakley Creek and the other slips areas to the north of the Causeway. The marine benthic habitat monitoring in July and August will be a further focus.

APPENDIX A – SH16 CAUSEWAY UPGRADE PROJECT IMPORTED AND EXPORTED MATERIALS SUMMARY

**APPENDIX B – SH16 CAUSEWAY UPGRADE PROJECT CONSTRUCTION
ZONES PLAN**

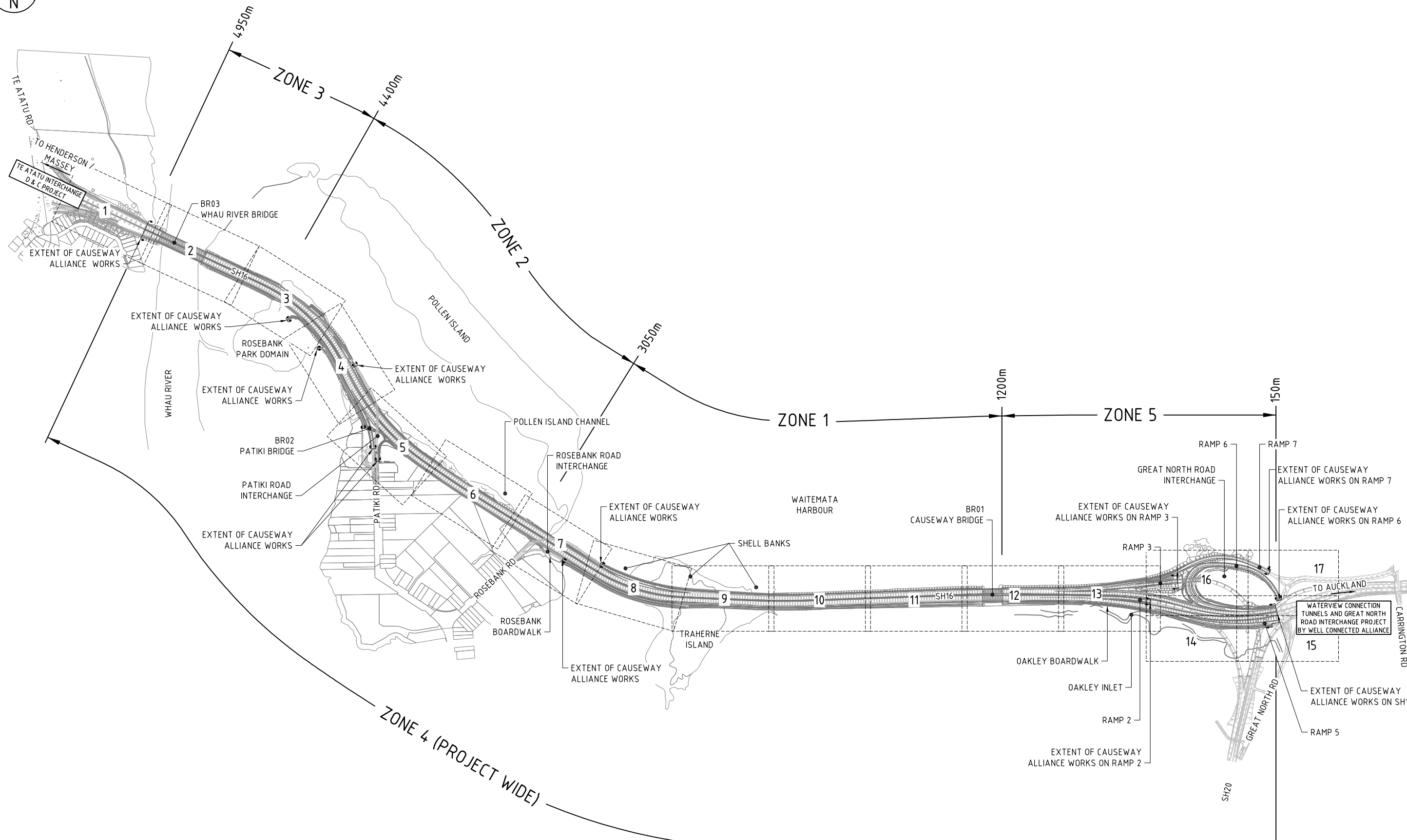

TE ATATU RD

TO HENDERSON / MASSEY
TE ATATU INTERCHANGE
D & C PROJECT

1
EXTENT OF CAUSEWAY
ALLIANCE WORKS

BR03
WHAU RIVER BRIDGE

2

EXTENT OF CAUSEWAY
ALLIANCE WORKS

ROSEBANK
PARK DOMAIN

EXTENT OF CAUSEWAY
ALLIANCE WORKS

WHAU RIVER

BR02
PATIKI BRIDGE

PATIKI ROAD
INTERCHANGE

EXTENT OF CAUSEWAY
ALLIANCE WORKS

PATIKI RD

5

EXTENT OF CAUSEWAY
ALLIANCE WORKS

POLLEN ISLAND
CHANNEL

ROSEBANK ROAD
INTERCHANGE

ROSEBANK RD

ROSEBANK
BOARDWALK

EXTENT OF CAUSEWAY
ALLIANCE WORKS

TRAHERNE
ISLAND

SHELL BANKS

WAITEMATA
HARBOUR

BR01
CAUSEWAY BRIDGE

SH16

OAKLEY BOARDWALK

OAKLEY INLET

RAMP 2

EXTENT OF CAUSEWAY
ALLIANCE WORKS ON RAMP 2

1200m

ZONE 1

ZONE 5

150m

RAMP 6

RAMP 7

GREAT NORTH ROAD
INTERCHANGE

EXTENT OF CAUSEWAY
ALLIANCE WORKS ON RAMP 3

RAMP 3

EXTENT OF CAUSEWAY
ALLIANCE WORKS ON RAMP 7

EXTENT OF CAUSEWAY
ALLIANCE WORKS ON RAMP 6

16

17

WATERVIEW CONNECTION
TUNNELS AND GREAT NORTH
ROAD INTERCHANGE PROJECT
BY WELL CONNECTED ALLIANCE

15

EXTENT OF CAUSEWAY
ALLIANCE WORKS ON SH16

RAMP 5

SH20

ZONE 4 (PROJECT WIDE)

4950m

ZONE 3

4400m

ZONE 2

3050m

CARRINGTON RD

TO AUCKLAND