

HYDRANT INSPECTION

In lane of a 2 way 2 lane road

Posted speed up to and including 60 km/h

TMD 1

Notes:

1. If posted speed is over 60 km/h, use contracted traffic management services and full temporary traffic management
2. All vehicles must display amber and/or red flashing beacon/s (not hazard lights) clearly visible to approaching traffic
3. If shadow vehicle is a Fire Appliance, display a RD6R arrow at rear
4. If shadow vehicle is not a Fire Appliance, display a TV4 PASS WITH CARE sign and RD6R arrow at rear
5. If visibility is less than the 75m then place a traffic marshal/ or tail pilot vehicle 100m in advance of the shadow vehicle
6. The tail pilot vehicle to have an amber/red flashing beacon and a RD6R arrow at rear

Equipment list

- 3 cones minimum
- RD6R on shadow vehicle
- RD6R on tail pilot (if used)

Legend:

Working Space
 Safety Zones

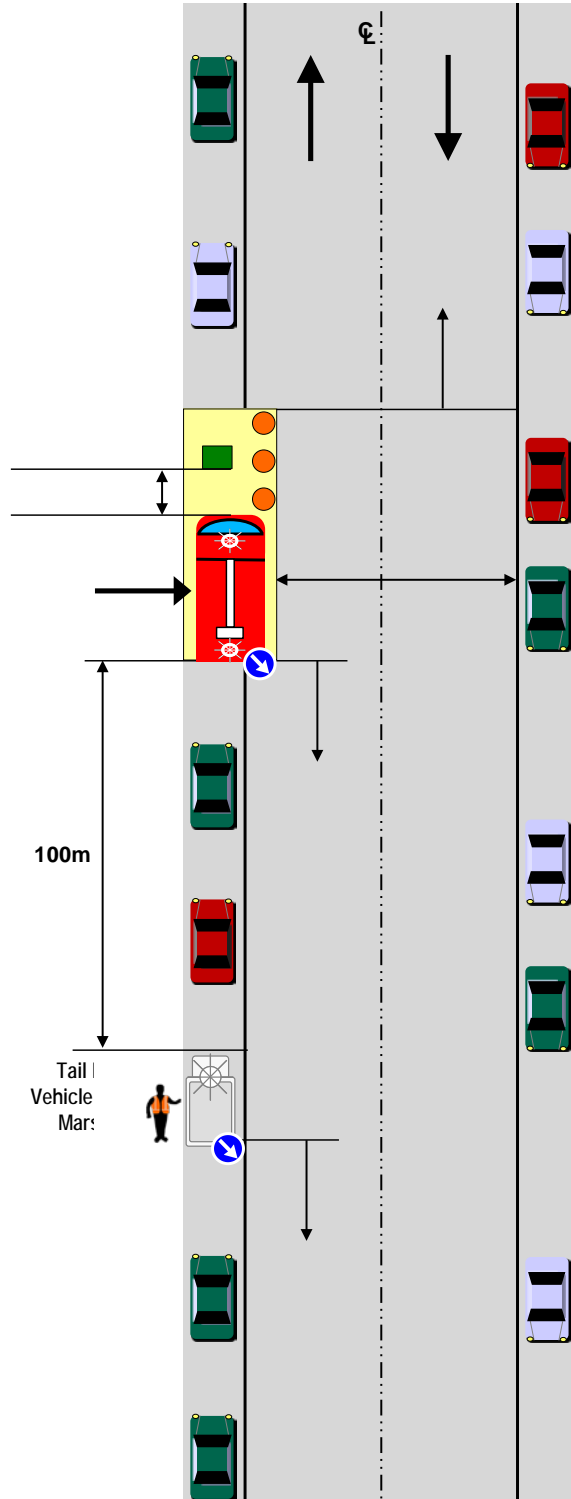

NOT TO SCALE

FLOW TESTING

In lane of a 2 way 2 lane road

Posted speed up to and including 60 km/h

TMD 2

Notes:

1. If posted speed is over 60 km/h, use contracted traffic management services and full temporary traffic management
2. All vehicles must display amber and/or red flashing beacon/s (not hazard lights) clearly visible to approaching traffic
3. If shadow vehicle is a Fire Appliance, display a RD6R arrow at rear
4. If shadow vehicle is not a Fire Appliance, display a TV4 PASS WITH CARE sign and RD6R arrow at rear
5. If visibility is less than the 75m then place a traffic marshal/ or tail pilot vehicle 100m in advance of the shadow vehicle
6. The tail pilot vehicle to have an amber/red flashing beacon and a RD6R arrow at rear
7. Shadow vehicle must be onsite with beacons flashing before cones at 2nd hydrant are set up

Equipment list

- 9 cones minimum
- RD6R on shadow vehicle
- RD6R on tail pilot (if used)

Legend:

Working Space
 Safety Zones

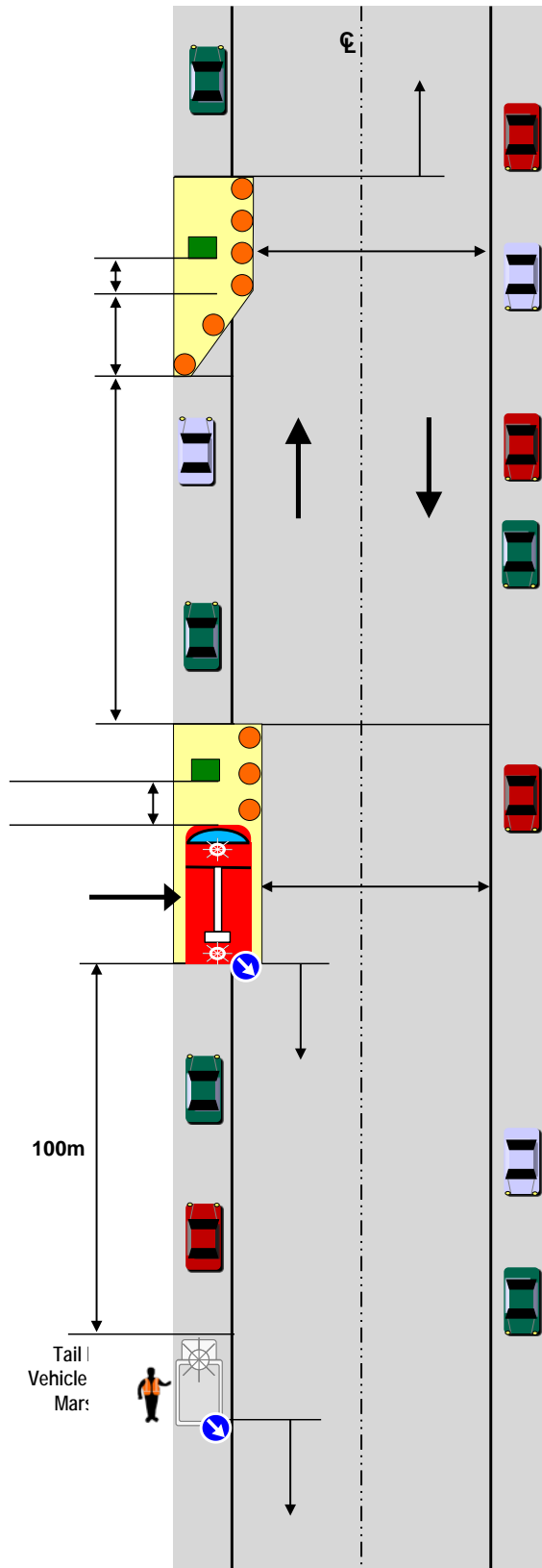

NOT TO SCALE